

Grades for Madison Ave 27th to 28th

July 17th 1900 J. M. Lutz Rod

Ordered thru by Street Com.

Obs. — S.E. grade

M.A. 28th ch. corr

4396.77
+ 0.21
96.95

2.98
8.48
4.98
4.98
4.94

4893.00 by M.A. 28th (set stake 1' high
above grade)
92.50 100' North same
92.00 200 " on grade
92.00 300 " " "
92.00 400 " " "

- 4.98

92.00 T.P.

+ 4.34

96.34

3.84
3.34
2.84

92.50 500 " on grade
92.00 600 " " "
92.50 700 " " "

all set in Center Madison

- 1.07 94.37 Man hole 27th St.

96.37

+ 4.93

90.30

- 6.20
- 6.80
- 5.10
- 7.50
- 1.00

93.10
92.50
94.20
91.80
96.30

S.W. Cor. 28th & Mad. } incl. stake
250' W on 27th S curb }
Set at end of Box Man. on 27 }
Bottom Rd }
Set man hole 27

27 = 92136.35

26 = 100

25 = 107762.00

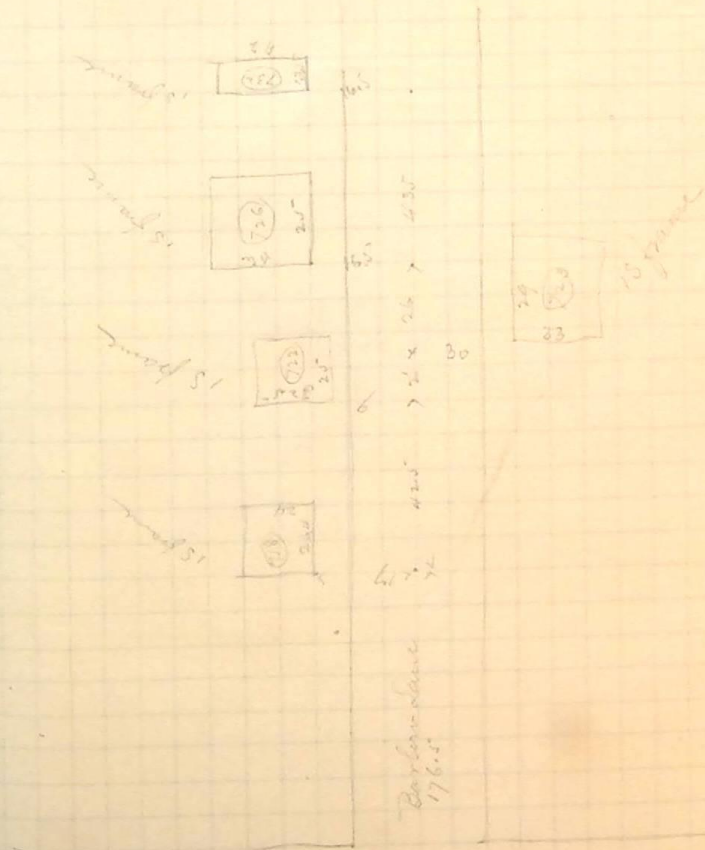

Madison 924 10.31